

POLY BATTS

SoftTM touch

Polyester Insulation



POLY BATTS

The Soft Option!

Poly Batts, the insulation that is soft to the touch when you install them, and provide excellent thermal performance for the life of the home, while meeting Australian Building Code requirements.

In addition to saving on energy bills, your home is more comfortable and greenhouse gas emissions are reduced, which is great for the environment and Poly Batts last for the life of the home.

Poly Batts are made from 100% polyester fibre, making them soft and pleasant to handle, which is a real benefit during installation, especially if you are doing it yourself.



R-value	Batts Size (mm)	Nominal Thickness (mm)	Batts per pack	Area per pack (m ²)	Coverage per pack (m ²)
R1.5	1160 X 430	90	16	8.0	9.0
	1160 X 580	90	16	10.8	12.2
R2.0	1160 X 430	120	16	8.0	9.0
	1160 X 580	120	16	10.8	12.2
R2.5	1160 X 430	160	12	6.0	6.7
	1160 X 580	160	12	8.1	9.1
R3.0	1160 X 430	170	12	6.0	6.7
	1160 X 580	170	12	8.1	9.1
R3.5	1160 X 430	190	8	4.0	4.5
	1160 X 580	190	8	5.4	6.1
R4.0	1160 X 430	200	8	4.0	4.5
	1160 X 580	200	8	5.4	6.1



No Noise, No Problem!

If noise is a problem in your household, we've got you covered with high-performance Polycoustic Batts.

By installing Polycoustic Batts in your external walls you can cut down on the level of noise entering the home from traffic, trains and other outside disturbances while providing higher R-values (thermal performance).

Installing Polycoustic Batts in the internal walls will help improve the level of privacy within your home and cut down on the level of noise transference between rooms.

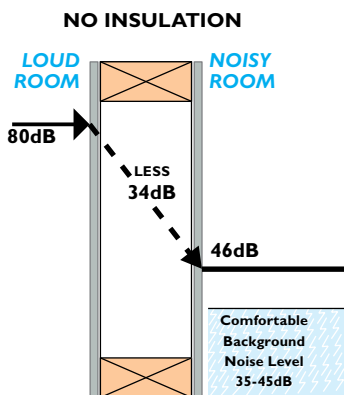

Wall Rating: Rw 34

Insulation: Nil
Studs: 90mm timber
Plasterboard: 10mm standard core

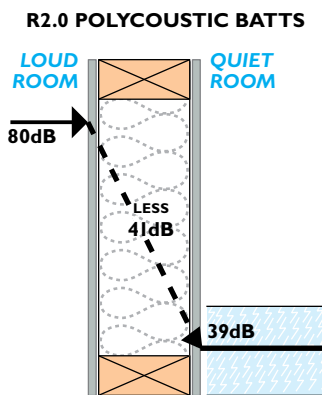

Wall Rating: Rw 41

Insulation: R2.0 Polycoustic Batts
Studs: 90mm timber
Plasterboard: 10mm standard core

R-value	Batts Size (mm)	Nominal Thickness (mm)	Batts per pack	Area per pack (m ²)	Coverage per pack (m ²)
R1.5	1160 X 430	75	16	8.0	9.0
	1160 X 580	75	16	10.8	12.2
R2.0	1160 X 430	90	12	6.0	6.7
	1160 X 580	90	12	8.1	9.1
R2.5	1160 X 430	90	8	4.0	4.5
	1160 X 580	90	8	5.4	6.1



You'll Be Floored!

Floors are typically not an area many consider for insulation, but it is an area that accounts for up to 15% of heating and cooling loss.

Applying Cosyfloor to the underside of a suspended floor is an easy way to improve the warmth and comfort of your home, especially in winter. Floor insulation will also save on energy costs and help meet local energy efficiency requirements, especially for 5-star homes.

Cosyfloor can be easily installed between floor joist from above during new home construction before the floor is laid or from beneath in an existing home. Cosyfloor will friction fit between 450mm centred floor joist then should be stapled every 300mm to keep in place for the life of the home.



R-value	Length (m)	Width (mm)	Rolls per pack	Coverage per pack (m ²)
R1.5	10	450	2	9.0
R2.0	10	450	2	9.0

How many packs do you need?

Product		R1.5 Polybatts R2.0 Polybatts R1.5 Polycoustic		R2.5 Polybatts R3.0 Polybatts R2.0 Polycoustic		R3.5 Polybatts R4.0 Polybatts R2.5 Polycoustic	
Timber Centres		450	600	450	600	450	600
Batt Size (mm)		1160 x 430	1160 x 580	1160 x 430	1160 x 580	1160 x 430	1160 x 580
Batts Per Pack		16	16	12	12	8	8
Wall/Ceiling Area Sq m ²		NUMBER OF PACKS REQUIRED					
5	46	6	4	7	6	11	8
6	56	7	5	9	7	13	10
7	65	8	6	10	8	15	11
8	74	9	7	12	9	17	13
9	84	10	7	13	10	19	14
10	93	11	8	14	11	21	16
11	102	12	9	16	12	23	17
12	111	13	10	17	13	25	19
13	121	14	10	19	14	27	20
14	130	15	11	20	15	29	22
15	139	16	12	21	16	31	23
16	149	17	13	23	17	34	25
17	158	18	13	24	18	36	26
18	167	19	14	25	19	38	28
19	177	20	15	27	20	40	29
20	186	21	16	28	21	42	31

This chart provides an approximate number of packs required for a given wall or ceiling area. This may vary due to the amount of timber in the wall and ceiling areas and openings such as skylights, windows, etc.

Why install Poly Batts

- Improves comfort in summer and winter
- Reduces sound transmission in ceilings and walls
- Comfort for your ears
- Pays for itself many times over
- Saves on your energy bills
- Your heater and air-conditioner will run more efficiently
- Reduces energy consumption
- Provides the opportunity to use smaller air conditioning units
- Soft to touch and easy to install
- Reduces Greenhouse gas emissions
- Your positive contribution to helping stop climate change

**LOW
ALLERGEN**

- Made from 100% polyester fibre
- No irritation or allergic reactions



- Made in Australia



For more information contact Fletcher Insulation on
sales@insulation.com.au or call **1300 65 44 44**
or visit **www.insulation.com.au**

Available from:

